



# CONSTRUCTION NEWS

## Eglinton Subway Station Temporary Bus Terminal and Elevator Installation Work

Beginning late February 2003, the TTC will start construction of a temporary bus terminal on the vacated Eglinton Bus Garage site accessed via Duplex Avenue and Berwick Avenue near the Eglinton Subway Station at Yonge Street. This work is scheduled for completion by the end of 2003 at which time bus terminal operations will be temporarily moved to the bus garage and the existing bus terminal will be closed. In addition, the automatic subway entrance located on the west side of Yonge Street between Eglinton Avenue and Berwick Avenue will be upgraded to improve public access for persons with disabilities. The Eglinton Station will be fully accessible by summer 2004. **See drawing on next page.**

**EXTENT OF WORK:** The majority of the work will occur inside the Eglinton Bus Garage and includes:

- Construction of a ten bus-bay platform, roadway resurfacing, reconfiguration of the garage floor plan to allow for bus operations and minor changes to the exterior walls of the existing garage.
- Construction of a bus platform for special events in the area of the Duplex entrance.
- Relocation of two hydro poles in order to widen and grade the existing curb entrance at Duplex Avenue and widen the existing curb entrance into the garage at Berwick Avenue.
- Demolition of bus bay #1 at the existing bus terminal to allow for the construction of an underground passenger walkway that will connect the subway concourse level to the temporary bus terminal inside the bus garage.
- Modifications to the Yonge Street automatic subway entrance that will provide direct access to the temporary bus platform in the bus garage and retrofit the entrance with an elevator, complete with closed circuit television and intercoms, a wide fare gate to accommodate people in wheelchairs. The elevator will provide access between street level to the subway platform level.

### WORK HOURS:

Work at street level will be largely confined to the hours of 7 a.m. and 6 p.m. on weekdays. Occasionally, the Contractor may need to work later in the day or on weekends. When this happens, efforts will be made to keep noise levels to a minimum and limit the use of heavy equipment after 11 p.m. Work inside the bus garage and station will require some overnight activities.

### TRAFFIC AND PEDESTRIAN IMPACTS:

Traffic and pedestrian movement will be maintained on Duplex Avenue and Berwick Avenue during the construction. Access into the Eglinton Station via the Yonge Street automatic entrance will be restricted during a portion of the construction.

### TRANSIT SERVICES:

Subway and bus service will be maintained at all times. Bus egress from the existing bus terminal may at times vary to accommodate phases of construction.

We look forward to full implementation of these new and temporary features at Eglinton Station, and regret any inconvenience that may be caused as a result of this project.

*Diego Sinagoga*  
Community Liaison Representative

February 24, 2003



TORONTO TRANSIT COMMISSION

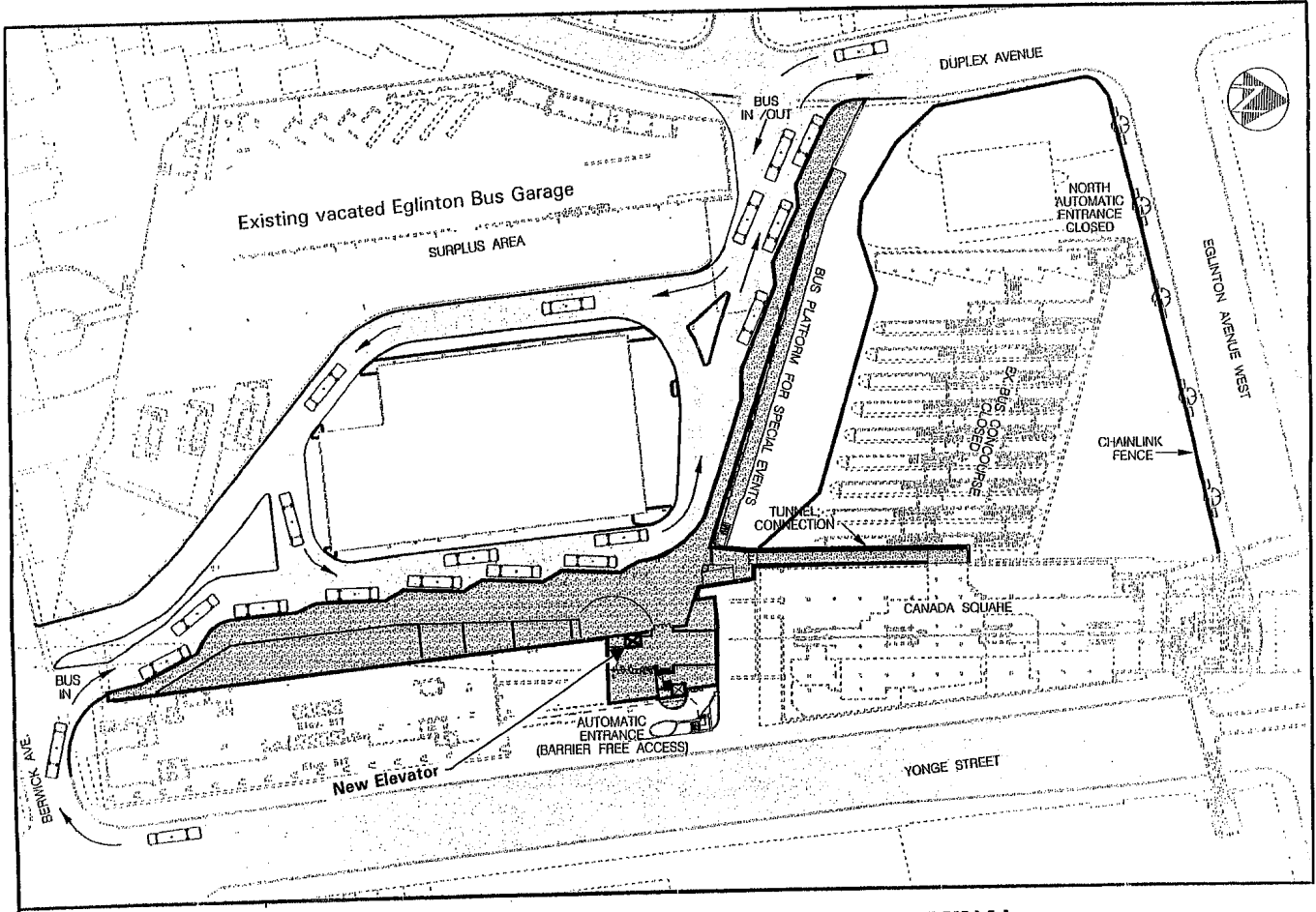

**EGLINTON STATION TEMPORARY BUS TERMINAL  
AND ELEVATOR INSTALLATION**

